

Cross Road and Fullarton Road Intersection Upgrade

Urrbrae gatehouse - decommissioning fact sheet

The Australian and South Australian governments have jointly (50:50) committed \$61 million to upgrade the Cross Road and Fullarton Road intersection. Once complete, the upgrade will improve travel times and road safety, increase intersection capacity and enhance network reliability.

Due to design constraints, the heritage listed Urrbrae Gatehouse cannot be retained in its current location. After considering feedback from the broader community and the University of Adelaide, the Department for Infrastructure and Transport plan to relocate the Gatehouse to a new site on Claremont Avenue, Urrbrae, as proposed by the University of Adelaide

Decommissioning of the Urrbrae Gatehouse has commenced and is scheduled to be completed by mid-2022. The rebuilding process using the key Heritage elements will begin mid-2022 and be completed by late 2022.

Decommissioning methodology

The decommissioning process includes accurately recording key parts of the building, carefully cleaning, labelling parts and finally storing them safely ready to be reused when the gatehouse is reconstructed.

Key techniques and methodologies have been developed with master trades and heritage building experts.

The main steps involved in the demolition include:

- Prior to any works commencing, documentation of the existing building will be completed. This includes detailed photographs of all elements and a 3D scan that will be used as reference.

- Timber architraves, skirtings, door frames and flooring will then be carefully removed, labelled and bundled, to protect them from damage and potential exposure to weather following the removal of the roof.
- Existing asbestos, roof shingles and roof drainage (gutters and downpipes) will be removed by a licenced asbestos removalist. Note, these items are not original heritage elements.
- Chimneys will be deconstructed by removing bricks one at the time. The bricks will then be carefully cleaned, catalogued and placed onto a pallet for storage. Prior to the removal of all stones and bricks, details of their location will be recorded and cross referenced with the drawings and photographs.
- External stone and brickwork will be deconstructed step by step, carefully removing all internal plaster and mortar to expose the stone and brick. All masonry and stone will be carefully cleaned by hand as it is removed.
- Window and door frames will be removed as surrounding wall sections are deconstructed. Windows will be stored in timber boxes for their protection before use in the reconstruction phase.

dit.sa.gov.au

Follow us on:    



Australian Government

BUILDING OUR FUTURE



Government of South Australia

Department for Infrastructure and Transport

Building Sections for Deconstruction

The plans and elevations provided below indicate the different parts of the building with respect to State Heritage and the Urrbrae Gatehouse's Listing.

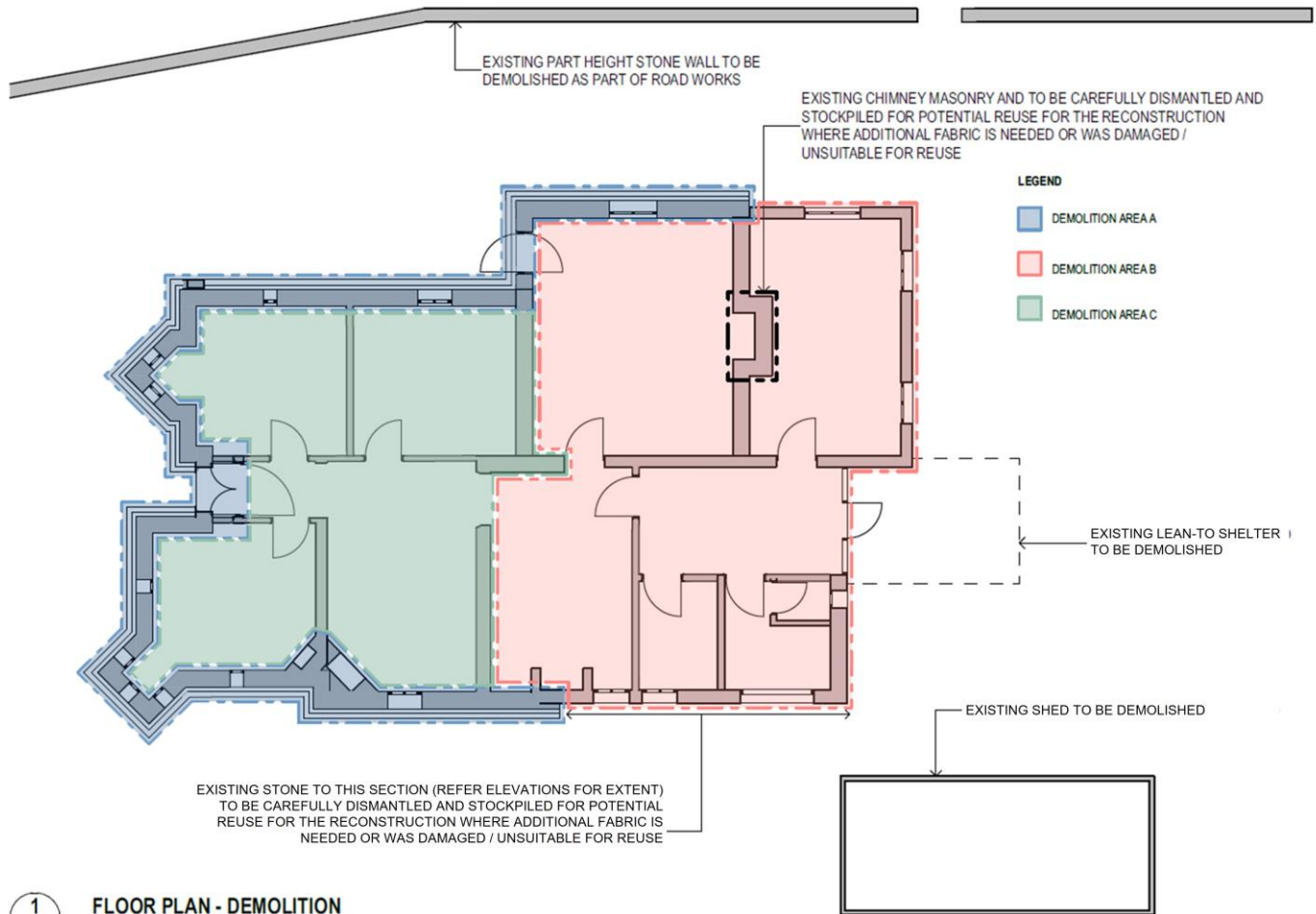

1 FLOOR PLAN - DEMOLITION

Demolition Area A



External Heritage elements - these items include stonework, brickwork, windows and doors and will be carefully deconstructed with all materials salvaged for re-use.

1. Demolition Area B



Non-heritage internal and external elements - these items vary from original heritage items and will not be re-used.

2. Demolition Area C



Heritage and Non-heritage internal elements - these items include floorboards, door frames and skirtings and will be carefully deconstructed as they can be re-used as original and supplementary materials.

Further information

If you have any further enquiries or would like to register for project updates, please: visit www.dit.sa.gov.au/cross_fullarton, email DIT.CrossFullarton@sa.gov.au or telephone 1300 794 880