



South Eastern Freeway Pavement Rehabilitation – Tollgate to Heysen Tunnels

Stage 2 Works, 2 – 25 March 2021

The South Eastern Freeway pavement rehabilitation stage two works will be undertaken from Tuesday, 2 March, until approximately Thursday, 25 March 2021, weather permitting.

These works will take place on the city bound lanes of the freeway, between just west of the Mount Barker Road uphill off-ramp (west of the tunnels) and the Tollgate.

Times of works

To safely facilitate the works and minimise impact to road users, the works will be undertaken at night from Sunday to Friday at the following times, weather permitting:

- Sunday evening between 5pm and 6am Monday;
- Monday to Thursday between 7pm and 6am; and
- Friday between 7pm and 8am Saturday.

Please note that night works will be undertaken on the Adelaide Cup long weekend, on Sunday, 7 March and Monday, 8 March. In the event of catastrophic fire danger conditions no works will be undertaken.

What to expect

The city bound lanes of the freeway in this location will be closed, with vehicles directed onto the opposite side of the freeway. One lane of traffic will operate in the uphill direction and two lanes will operate in the downhill direction. Light vehicles travelling uphill are encouraged to use Mount Barker Road to help reduce congestion during night working hours.

Local Access:

- **The city bound Mount Osmond Road off-ramp will be closed during these night works. It will also be closed during the day from Tuesday, 2 March until approximately Monday, 15 March** Vehicles will be required to continue travelling city bound on the freeway, turn right onto Portrush Road, right onto Gilles Road, left onto Sunnyside Road, right onto Thirkell Terrace and then continue onto Hayward Drive and Mount Osmond Road. Please see the maps overleaf for further details;
- **The city bound Mount Osmond Road on-ramp will be closed during these night works. It will also be closed during the day on Tuesday, 2 March until approximately Monday, 15 March** Vehicles will be required to detour via the uphill Mount Osmond Road on-ramp and then take the

dit.sa.gov.au

Follow us on:



Australian Government

BUILDING OUR FUTURE



Government
of South Australia



**BUILDING
WHAT MATTERS**

Mount Barker Road off-ramp, use the overpass and then re-enter the freeway city bound via the Mount Barker Road on-ramp. Please see the maps overleaf for further details;

- **The city bound Mount Barker Road on-ramp at Leawood Gardens will be closed from 2 – 8 March during night works. There may also be a requirement for it to be closed during the day on Saturday 6 and Sunday 7 March.** Vehicles will be required to detour via Mount Barker Road and enter the freeway at the Crafers Interchange in order to travel city bound;
- **Access to the Mira Monte Estate:** Restricted access will be maintained at all times. Detailed information will be provided to Mira Monte residents; and
- **Access between Portrush Road and Gill Terrace:** Will be restricted to left in, left out only during nightworks and the u-turn facility adjacent the tollgate will be closed. Vehicles exiting properties wanting to travel city bound will need to either turn left onto the freeway and then use the Mount Barker Road off-ramp to turn around re-enter the freeway city bound or detour via Sunnyside Road, Gilles Road and Portrush Road.

A detour will be in place for cyclists and pedestrians during night works, via Glebe Road, Pridmore Road, Derrington Avenue, Boucaut Street, then the footpath between Boucaut Street and Gill Terrace and the freeway verge. Please see the night works plan for further details.

During night works, speeds for downhill light vehicle traffic will be restricted to 40kph from Measdays Bridge then 25kph from the Mount Osmond Interchange to the Portrush Road intersection. Speeds for uphill traffic will be restricted to 40kph through the work zone, returning to the posted speed outside of this location. Speeds for heavy vehicles will be restricted to 40kph from the Crafers Interchange and then 25kph from the Mount Osmond Interchange to the Portrush Road intersection.

During the day, a single city bound lane closure will be in place through the work area and speed restrictions of 60kph will be in place on the downhill lanes of the freeway from the Measdays Bridge, to allow heavy vehicles and light vehicles to be travelling at the same speed prior to any lane closure. Speed restrictions will also be in place for uphill traffic adjacent the work zone. Outside of this, speeds for uphill traffic will not be affected.

Bus stop 16 (downhill) will be closed during night works. It will also be closed during the day from Tuesday, 2 March – Monday, 15 March.

Heavy vehicles, including buses, will have access on the freeway throughout works, with the upper arrestor bed available at all times. **A closure of the lower arrestor bed is expected to be in place for a short period during the day works. A truck mounted attenuator will be in place prior to the work zone during this time.**

Signage will be in place at key locations to provide advance notice of the traffic restrictions. Motorists should expect delays, so please plan ahead and allow additional travel time. Please take extra care when workers are on site. Observe signage and speed limits, lane restrictions and traffic controllers when travelling through the area. The Department appreciates your patience and cooperation while these important works are undertaken.

Further information

For more information on the project or to register for project updates, please contact the project team via:

- **visit:** www.dit.sa.gov.au/SEFreeway
- **email:** dit.communityrelations@sa.gov.au
- **telephone:** 1300 103 456
- **SitePodium:** stay up to date with the project via the SitePodium app, visit www.dit.sa.gov.au/sefreeway for details on how to download the app.

Kind regards
South Eastern Freeway Pavement Rehabilitation Project Team



Stage 2 Heysen Tunnels to Tollgate, city bound lanes: Night works traffic restrictions
 Tuesday 2 March – Thursday 25 March (weather permitting)

Night works schedule (weather permitting)

7pm - 6am, Monday - Friday
 7pm Friday - 8am Saturday
 5pm Sunday - 6am Monday

Speed Restrictions

Speeds for downhill light vehicle traffic will be restricted to 40kph from Measdays Bridge and then 25kph from the Mount Osmond Interchange to the Portrush Road intersection.

Speeds for uphill traffic will be restricted to 40kph through the work zone and will then return to the posted speed outside of this location.

Speeds for heavy vehicles will be restricted to 40kph from the Crafers Interchange and then 25kph from the Mount Osmond Interchange to the Portrush Road intersection.

Thank you for your patience, drive safely.

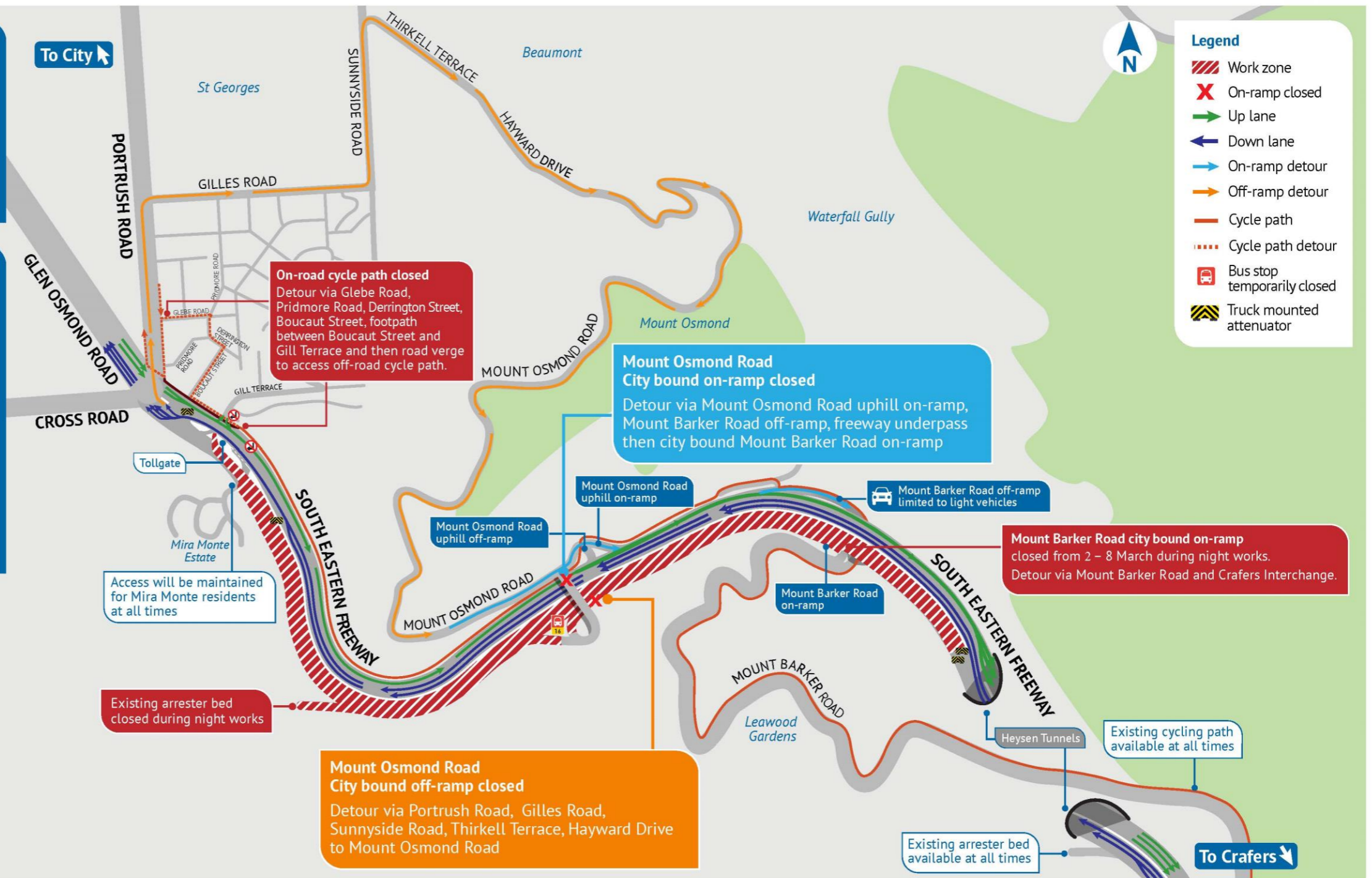

www.dit.sa.gov.au/SEFreeway
 1300 103 456

Follow us on:

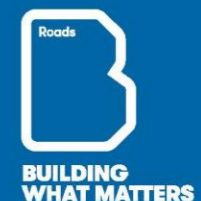



Stage 2 Heysen Tunnels to Tollgate, city bound lanes: Day time traffic restrictions

Tuesday 2 March – Thursday 25 March (weather permitting)

Day time traffic restrictions (weather permitting)

Monday to Friday: 6am - 7pm
Weekends: 8am Saturday - 7pm Sunday

Speed Restrictions

For city bound lanes, speed restrictions of 60kph will commence from approximately the Measdays Bridge, to allow heavy vehicles and light vehicles to be travelling at the same speed prior to any lane closure. This reduces the likelihood of collisions and reduces the severity if a collision was to occur. Speed restrictions will be in place for uphill traffic adjacent the work zone. Outside of this, speeds for uphill traffic will not be affected.

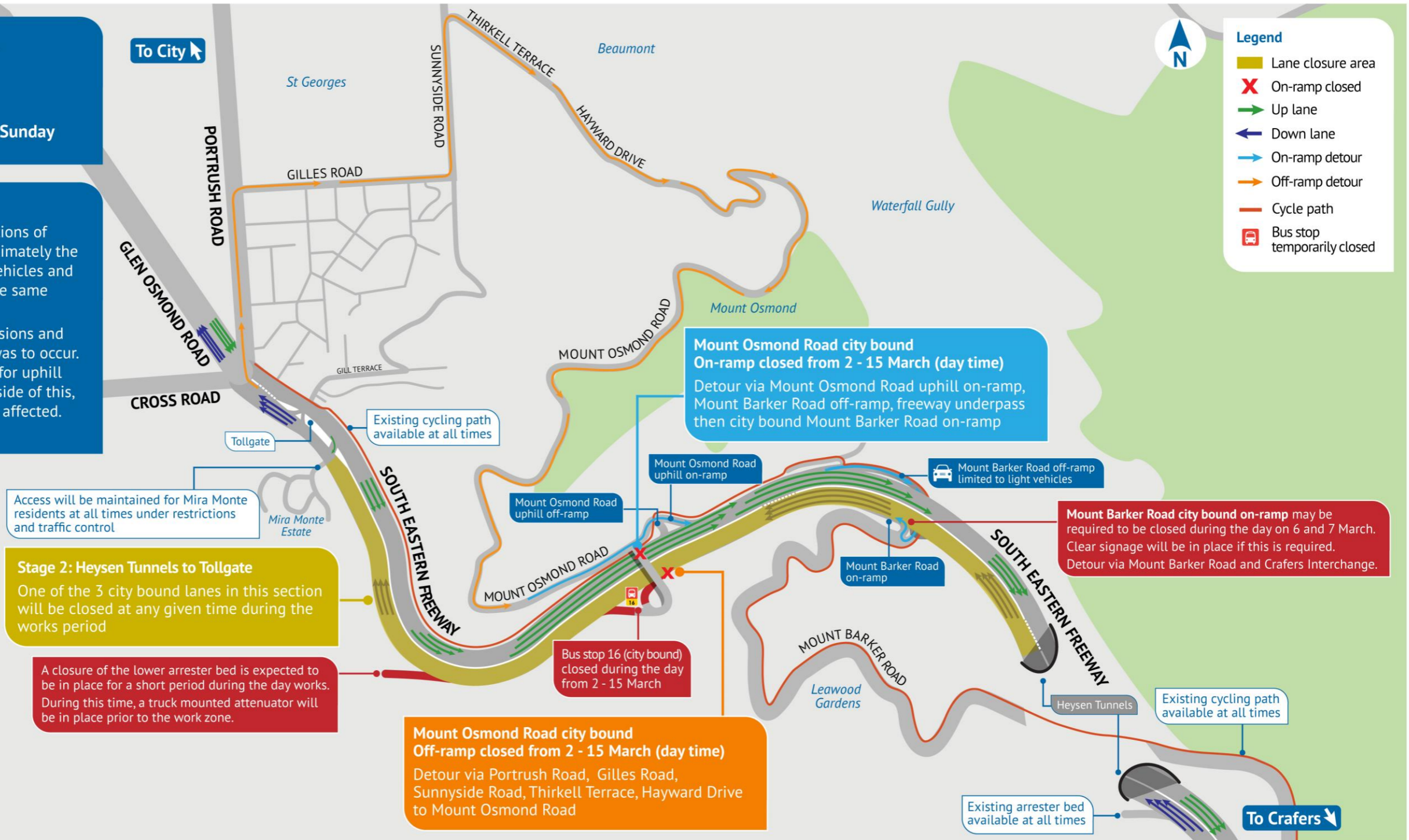

Stage 2: Heysen Tunnels to Tollgate
One of the 3 city bound lanes in this section will be closed at any given time during the works period

A closure of the lower arreser bed is expected to be in place for a short period during the day works. During this time, a truck mounted attenuator will be in place prior to the work zone.

Mount Osmond Road city bound Off-ramp closed from 2 - 15 March (day time)
Detour via Portrush Road, Gilles Road, Sunnyside Road, Thirkell Terrace, Hayward Drive to Mount Osmond Road

Mount Osmond Road city bound On-ramp closed from 2 - 15 March (day time)
Detour via Mount Osmond Road uphill on-ramp, Mount Barker Road off-ramp, freeway underpass then city bound Mount Barker Road on-ramp

Mount Barker Road city bound on-ramp may be required to be closed during the day on 6 and 7 March. Clear signage will be in place if this is required. Detour via Mount Barker Road and Crafers Interchange.