



# South Eastern Freeway Pavement Rehabilitation Project

## Project Update – Tollgate to Heysen Tunnels and Measday Bridge, May to June 2021

We are pleased to confirm Stage 3 pavement works are nearing completion and the construction of a temporary crossover in the median (west of Measday Bridge) will begin shortly. This will allow pavement works to begin to the east of the Heysen Tunnels. These works will require traffic restrictions, both during the day and night. Please plan ahead, allow extra travel time and take extra care when workers are on site.

### Completion of Stage 3 pavement works – upcoming night works and associated temporary ramp closures

Work to complete the Stage 3 pavement works will be undertaken from Friday, 14 May 2021, to Sunday, 16 May 2021, weather permitting.

Work will involve laying the final layer of pavement on the outbound lanes of the freeway between the Tollgate and just west of the Mount Barker Road outbound off-ramp (west of the tunnels).

To minimise the impact to road users, and ensure the works can be completed safely and efficiently, these works are being undertaken at night during the following times:

- 7pm Friday, 14 May – 8:30am Saturday, 15 May;
- 6pm Saturday, 15 May – 8:30am Sunday, 16 May; and
- 6pm Sunday, 16 May – 6am Monday, 17 May.

**In the event of unfavourable weather conditions at night, these works may need to continue during the day on Saturday, 15 May and Sunday, 16 May 2021.**

### Contingency Weekend

If unfavourable conditions continue, night works will be undertaken on the following weekend. Please refer to the project website or DIT social media (see below for links).

To safely facilitate these works, the following traffic management will be in place:

The outbound Mount Osmond Road off-ramp	<ul style="list-style-type: none"> <li>• Temporarily closed during night works; and</li> <li>• Vehicles will need to continue travelling outbound on the freeway, use the Crafrers Interchange and re-enter the freeway citybound to then use the Mount Osmond off-ramp.</li> </ul>
---	---

[dit.sa.gov.au](http://dit.sa.gov.au)

Follow us on:



Australian Government

**BUILDING OUR FUTURE**



Government  
of South Australia



**BUILDING  
WHAT MATTERS**

The outbound Mount Osmond Road on-ramp	<ul style="list-style-type: none"> <li>Temporarily closed during night works; and</li> <li>Vehicles will be required to detour via Mount Osmond Road, Hayward Drive, Thirkell Terrace, Sunnyside Road, Gilles Road, Portrush Road, then proceed to access the freeway via the merged outbound lanes.</li> </ul>
Access between Portrush Road and Gill Terrace	<ul style="list-style-type: none"> <li>Vehicles exiting properties in this location, and wishing to travel outbound, will be escorted by a traffic controller to join the merged traffic lanes on the opposite carriageway; and</li> <li>Vehicles exiting properties in this location, and wishing to travel citybound, will be required to detour via the Crafers Interchange and then re-enter the freeway citybound. Alternatively, vehicles can detour via Gill Terrace, Sunnyside Road and Gilles Road.</li> </ul>
Access to Mira Monte Estate	<ul style="list-style-type: none"> <li>Left-in, left-out access will be maintained at all times;</li> <li>The right turn into Mira Monte Estate will temporarily not be available during night works;</li> <li>Vehicles will be required to detour via the Crafers Interchange and then re-enter the freeway citybound to turn left into the estate; and</li> <li>There may also be a short period of time during the day over the weekend where the right turn into Mira Monte will not be available and residents will be required to detour via the Crafers Interchange. If this occurs, clear signage will be in place and a text message update will be provided to residents.</li> </ul>
Access for cyclists and pedestrians	<ul style="list-style-type: none"> <li>A detour will be in place for cyclists and pedestrians via Glebe Road, Pridmore Road, Derrington Avenue, Boucaut Street, then onto the footpath between Boucaut Street and Gill Terrace and the freeway verge.</li> </ul>
Outbound travel	<ul style="list-style-type: none"> <li>Outbound lanes will be temporarily closed during night works. Vehicles will be directed onto the opposite side of the freeway to travel outbound;</li> <li>One lane of traffic will operate in the outbound direction and two lanes will operate in the citybound direction;</li> <li>Speeds for outbound light and heavy vehicle traffic will be restricted to 40km/h from just east of the Portrush Road intersection until just west of the Mt Barker Road outbound off-ramp.</li> <li>Following the completion of the works, the 60km/h speed restrictions will remain in place from the Tollgate to Heysen Tunnels until excess bitumen has been worn to a safe level. At this time, the posted speed limit will be reinstated.</li> </ul>
Citybound travel	<ul style="list-style-type: none"> <li>During night works, speeds for citybound light vehicle traffic will be restricted to 40km/h from just east of the Heysen Tunnels. Speeds for citybound heavy vehicles will be restricted to 40km/h from the Crafers Interchange.</li> <li>During the day, a single citybound lane closure will be in place through the work area, with speed restrictions of 60km/h.</li> </ul>

Please refer to the ‘**Stage 3 - Weekend Night Works**’ and ‘**Stage 3 - Weekend Daytime Traffic Restrictions**’ plans overleaf.

Bus stop 14 (outbound) and bus stop 16 (outbound) will be temporary closed during these night works. For further information regarding the changes to bus stops and timetables please visit [www.adelaidemetro.com.au](http://www.adelaidemetro.com.au)

Heavy vehicles, including buses, will have access on the freeway throughout the night works, with the lower and upper safety ramps available at all times.

### Crossover works west of Measday Bridge

Crossover works will be carried out shortly and will take approximately two weeks to complete, weather permitting.

To safety facilitate these works, the following traffic management will be in place:

- At night, speeds will be reduced to 40km/h (adjacent the work zone) in both directions. Outbound traffic will be reduced to one lane and citybound traffic will be reduced to two lanes.
- During the day, outbound traffic adjacent the work zone will be reduced to 40km/h. Citybound traffic will be reduced to two lanes and 60km/h.

### Stage 4 pavement works – upcoming night works and associated temporary ramp closures

The next stage of pavement work will begin shortly on the outbound lanes of the freeway, between just west of the Mount Barker Road outbound off-ramp and the Heysen Tunnels.

This work is expected to be complete in June 2021, weather permitting,

In order to minimise the impact to road users, the works will be undertaken at night from Sunday to Friday at the following times:

- Sunday between 6pm and 6am Monday;
- Monday to Thursday between 7pm and 6am; and
- Friday between 7pm and 8am Saturday.

### Planned traffic changes

To safely undertake these works, the following traffic arrangements will be in place:

Outbound lanes just west of the Mount Barker Road outbound off-ramp and the Heysen Tunnels	<ul style="list-style-type: none"> <li>• Outbound lanes will be temporarily closed during night works. Vehicles will be directed onto the opposite side of the freeway to travel outbound; and</li> <li>• One lane of traffic will operate in the outbound direction and two lanes will operate in the citybound direction.</li> </ul>
The outbound Mount Barker Road off-ramp (Eagle on the Hill/Devil's Elbow)	<ul style="list-style-type: none"> <li>• Closed during the day and night from mid-May for approximately two weeks;</li> <li>• Temporarily closed only at night for the remainder of the night works; and</li> <li>• Vehicles will need to continue travelling outbound on the freeway, use the Crafers Interchange and re-enter the freeway to then use the Mount Osmond citybound off-ramp.</li> </ul>
Access to Mira Monte Estate	<ul style="list-style-type: none"> <li>• No access impacts.</li> </ul>
Citybound travel	<ul style="list-style-type: none"> <li>• During night works, speeds for citybound light vehicle traffic will be restricted to 40km/h from Measday Bridge; and</li> <li>• Speeds for citybound heavy vehicles will be restricted to 40km/h from the Crafers Interchange.</li> </ul>

Outbound travel	<ul style="list-style-type: none"> <li>Speeds for outbound light and heavy vehicle traffic will be restricted to 40km/h from approximately the Mount Osmond Interchange until just east of the Heysen Tunnels.</li> </ul>
-----------------	---

Please refer to the ‘**Stage 4 Night Works Traffic Restrictions**’ and ‘**Stage 4 Daytime Traffic Restrictions**’ plans overleaf.

### Median works near the Tollgate – upcoming night works

Works will be undertaken to reconstruct the central median west of the Tollgate. This was removed in early 2021 to provide a temporary traffic crossover point.

These works are planned to start from mid to late May 2021 and will take approximately two weeks to complete, weather permitting.

In order to minimise the impact to road users, the works will be undertaken at night from Sunday to Friday at the following times:

- Sunday between 6pm and 6am Monday;
- Monday to Thursday between 7pm and 6am; and
- Friday between 7pm and 8am Saturday.

### Planned traffic changes

To safely undertake these works, the following traffic arrangements will be in place during these night works:

Citybound travel	<ul style="list-style-type: none"> <li>Citybound traffic will be reduced to one lane. Speed restrictions of 25km/h will also be in place from near the Mira Monte entrance.</li> <li>During the day, for a short period outbound traffic will be reduced to two lanes and 40km/h adjacent the work site and citybound traffic reduced to two lanes and 60km/h.</li> </ul>
Outbound travel	<ul style="list-style-type: none"> <li>Outbound traffic will be reduced to one lane from just east of the Portrush Road intersection until just east of Gill Terrace. Speed restrictions of 40km/h will also be in place.</li> </ul>

During the day, outbound traffic adjacent the work zone will be reduced to 40km/h. Citybound traffic will be reduced to two lanes and 60km/h.

### Important information for heavy vehicles

**Heavy vehicles greater than 3.4 metres wide will continue to not be permitted to travel in either direction on the South Eastern Freeway between the Glen Osmond Tollgate and the Stirling Interchange without a permit.**

Detour is via Murray Bridge via Hindmarsh Road, Maurice Road and Cypress Terrace and then follow Mannum Road towards the Sturt Highway via Randell Road, onto Ridley Road, Angus Valley Road and Halfway House Road, onto the Sturt Highway (and vice versa).

Heavy Vehicle operators may apply for permits to travel with widths greater than 3.4 metres or oversize and over mass requirements. Please contact the National Heavy Vehicle Regulator (NHVR) directly to apply for this permit.

---

## Further information

For more information on the project or to register for project updates, please contact the project team via:

- **visit:** [www.dit.sa.gov.au/SEFreeway](http://www.dit.sa.gov.au/SEFreeway)
- **email:** [dit.communityrelations@sa.gov.au](mailto:dit.communityrelations@sa.gov.au)
- **telephone:** 1300 103 456
- **SitePodium:** stay up to date with the project via the SitePodium app, visit [www.dit.sa.gov.au/sefreeway](http://www.dit.sa.gov.au/sefreeway) for details on how to download the app.
- **Addinsight:** get real-time traffic alerts whilst you are driving with the Addinsight smartphone app, visit [www.addinsight.com.au](http://www.addinsight.com.au)

The Department appreciates your patience and cooperation while these important works are undertaken.

Kind Regards

South Eastern Freeway Pavement Rehabilitation Project Team

---





Stage 4: Mount Barker Road to Heysen Tunnels, outbound lanes: Daytime traffic restrictions

Early May – Early June 2021 (weather permitting)

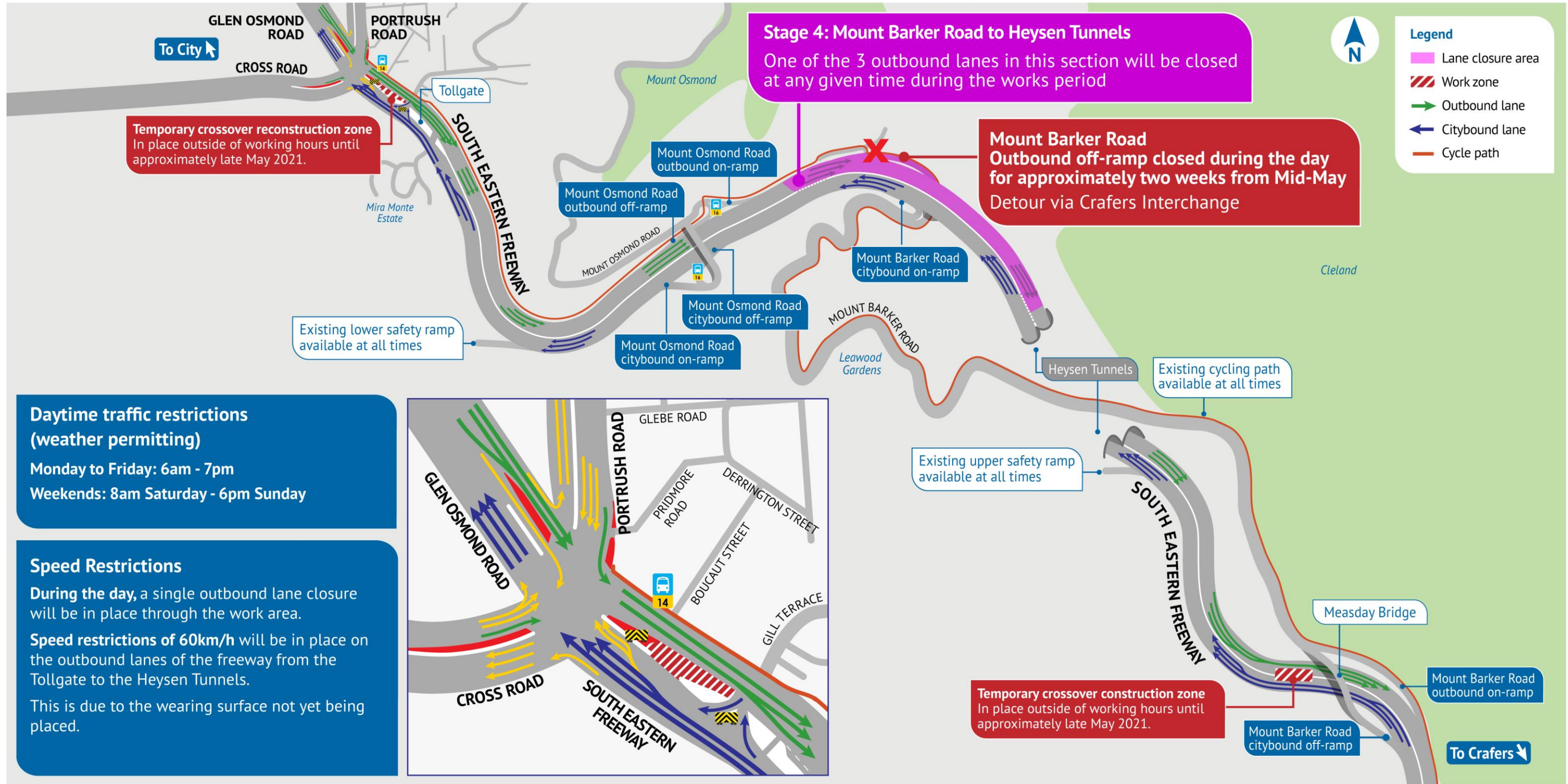



### Stage 3: Outbound lanes, Tollgate to Mount Barker Road: Weekend Night Works

14, 15 & 16 May 2021 (weather permitting)  
 21, 22 & 23 May 2021 (contingency weekend)

**Works schedule (weather permitting)**

7pm Friday, 14 May – 8:30am Saturday, 15 May  
 6pm Saturday, 15 May – 8:30am Sunday, 16 May  
 6pm Sunday, 16 May – 6am Monday, 17 May

In the event of inclement weather, works may continue throughout the day on Saturday 15 May and Sunday 16 May.

**Speed Restrictions**

During works, speeds for citybound light vehicle traffic will be restricted to 40km/h from just east of the Heysen Tunnels.

Speeds for outbound light and heavy vehicle traffic will be restricted to 40km/h from just east of the Portrush Road intersection until just west of the Mt Barker Road outbound off-ramp.

Speeds for citybound heavy vehicles will be restricted to 40km/h from the Crafers Interchange.

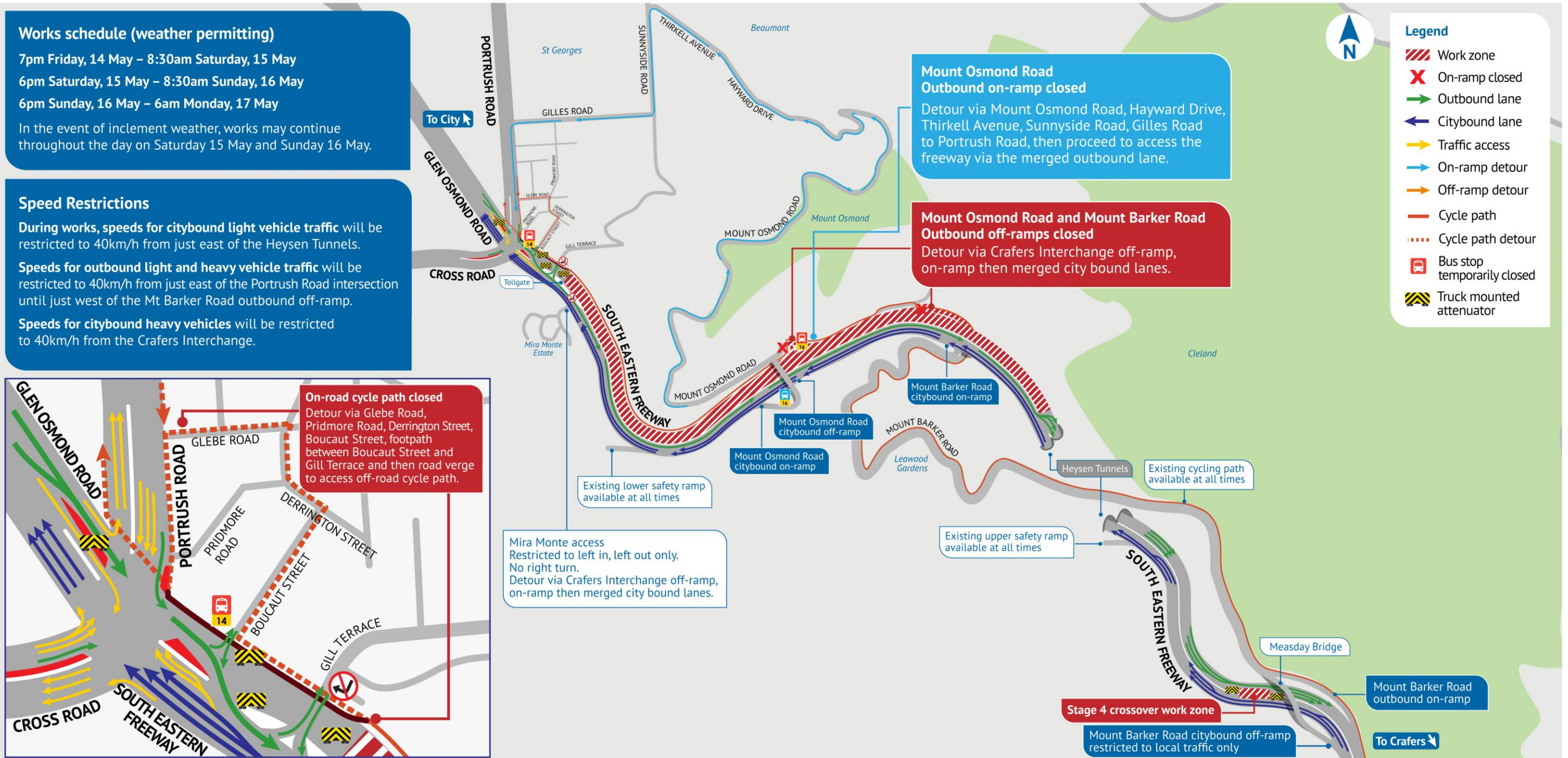

[www.dit.sa.gov.au/SEFreeway](http://www.dit.sa.gov.au/SEFreeway)

1300 103 456

Follow us on:







**Stage 3: Outbound lanes, Tollgate to Mount Barker Road: Weekend Daytime Traffic Restrictions**

15 & 16 May 2021 (weather permitting)  
 22 & 23 May 2021 (contingency weekend)

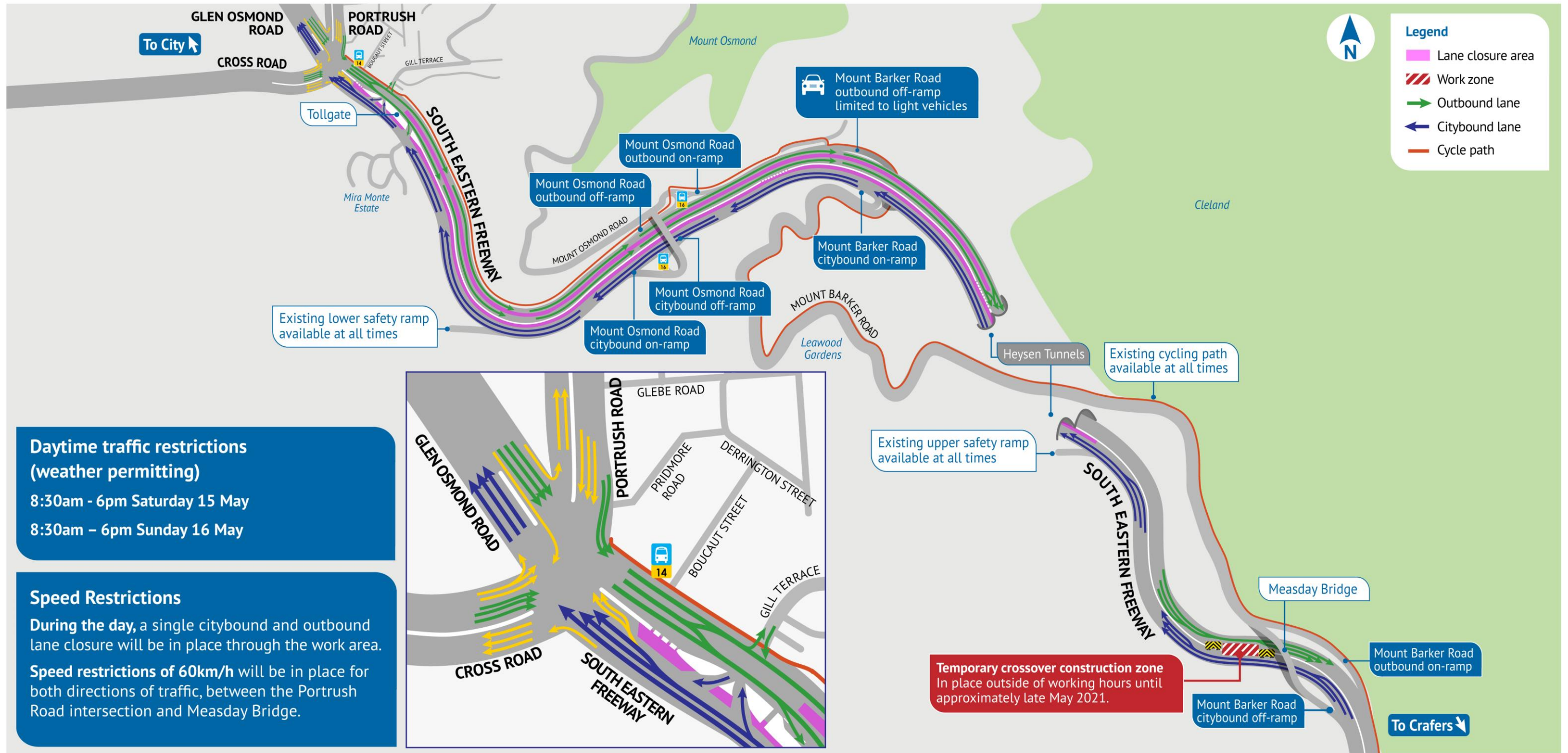

**Daytime traffic restrictions (weather permitting)**  
 8:30am - 6pm Saturday 15 May  
 8:30am - 6pm Sunday 16 May

**Speed Restrictions**  
 During the day, a single citybound and outbound lane closure will be in place through the work area.  
 Speed restrictions of 60km/h will be in place for both directions of traffic, between the Portrush Road intersection and Measday Bridge.