

Artist impression only – view from Marion Road looking south
Community feedback will inform urban design elements of the overpass



PROJECT UPDATE · March 2023

TRAM GRADE SEPARATION PROJECTS

The Australian and South Australian governments have jointly (50:50) funded \$400 million to remove the two level crossings where the Glenelg tram line crosses Marion Road and Cross Road, Plympton.

The existing tram overpass at South Road Glandore will also be re-built at the same time to support delivery of the River Torrens to Darlington Project. These works will all be delivered as part of the Tram Grade Separation Projects.

Planning work is also underway to investigate the potential removal of the level crossing at Morphett Road, Morphettville.

Why remove these level crossings?

Approximately 50,000 vehicles pass through these crossings each day. During the morning and afternoon peak around 30 trams also pass through, resulting in the boom gates being down for up to 20 minutes each hour.

Motorists currently experience congestion and variable travel times, particularly during these busy peak periods.

Congestion at these crossings causes significant delays, increased traffic through local streets, an increase in potential accidents as drivers take more risks and delays for public transport users.

Currently pedestrians and cyclists must navigate multiple tram crossings in order to access public transport services, local businesses and community services.

Planning to explore how best to remove these level crossings started in 2018. It included extensive technical investigations and early community engagement.

*AM peak is between 8am and 9am. PM peak is between 4:15pm and 5:15pm on Cross Road and between 4:30pm and 5:30pm on Marion Road.

Project benefits

Removing these level crossings will:

- reduce travel times for motorists, buses, freight and airport traffic
- improve safety for local residents, motorists, pedestrians, cyclists and tram drivers
- provide new, safer and more accessible tram stops with improved pedestrian access
- improve connection and sense of community between the suburbs either side of the tram line
- create new community open space for locals to enjoy

Removing the level crossings

Following extensive investigation work, an overpass has been determined as the best solution to remove the level crossings at Marion Road and Cross Road Plympton.

Compared to an underpass, this approach will:

- have the shortest construction time, minimising disruption to locals, as well as road and public transport users, during construction
- significantly reduce the number of properties needing to be acquired - all properties identified as being required for the project have been directly communicated with
- improve connection and safety between the suburbs either side of the tram line
- provide new public open space under the tram line
- be able to be delivered within the approved budget (an underpass cannot be delivered within the approved budget)

dit.sa.gov.au



Australian Government



Government of South Australia
Department for Infrastructure
and Transport



Key features of the Marion Road and Cross Road tram grade separations

Key features include:

- new Tram Stop 10 located between Marion Road and Cross Road
- new open community space and free-flow connections under the tram line
- lifts and stairs on the western and eastern sides of Marion Road
- elevated Mike Turtur Bikeway and shared use path alongside tram tracks

As part of the project, the capacity of turning lanes will be increased at the intersections of:

- Marion Road and Anzac Highway
- Marion Road and Cross Road

These upgrades will further ease congestion and improve travel times and safety.

Concept plans are currently being developed for the intersection upgrades and will be released shortly.

Why is the South Road overpass being upgraded?

Modification of the tram overpass at South Road will be required to facilitate the construction of the T2D Project.

While the tram line is closed to facilitate the removal of the level crossings at Marion Road and Cross Road, the Tram Grade Separation Projects team will utilise the tram line closure time to rebuild this overpass at the same time reducing impacts to tram and road users across the networks.

We look forward to engaging with the community in the coming months to help inform the detailed design for the new overpass, including local urban design elements.

Fast-tracking construction

To fast-track construction and reduce impacts on local residents, businesses, road and public transport users, closing the tram line is the best option. It is estimated the tram line will likely close for between 6 and 9 months. We are still working through the closure details to minimise impacts to commuters. For example it is our intention to still operate trams through the City and the parklands. Substitute buses will be in place during this time.

This will allow the overpasses to all be constructed at the same time.

This will significantly reduce the overall construction time and impacts that would otherwise be required if these projects were constructed separately.

Building an elevated tram line also allows major sections to be built off-site and craned into place, reducing construction impacts and timelines further.

Community and placemaking opportunities

Removing these level crossings will create new public spaces under the tram overpass.

As a new piece of the neighbourhood, we want to involve locals in the design of these spaces to ensure they become a place that people can enjoy.

The new spaces will include landscaping, public art and street furniture. There is also an opportunity to include other elements such as table tennis tables, basketball hoops and BBQs if this is something that is wanted by locals.

Examples of key features to be designed with community input



Landscaping and species selection

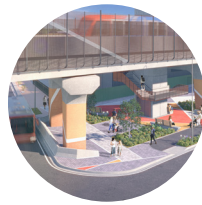

Open spaces under the tram line



Visual screens and buffers



Public art



Paving and other materials



Street furniture

The recently completed Ovingham Level Crossing Removal project is a great example of new open space delivered as part of the project, in collaboration with the local community. If you haven't been there yet, we encourage you to visit to take a look.

Alternatively, please get in contact with us and we can arrange a personalised tour of the new Ovingham community spaces.



New public space created as part of the Ovingham Level Crossing Removal Project



Your feedback is an important part of the design process

A concept design has been developed for the overpass to remove the two level crossings where the Glenelg tram line crosses Marion Road and Cross Road, Plympton. There is a lot more work to do to finalise urban design elements.

Community feedback will play an important role in informing the detailed design of the new public open spaces, visual screening, public art and landscaping that will be an important feature of the work. This will ensure the upgrades not only address the existing congestion and safety issues, but also create a welcoming and usable environment for the community to enjoy.

We will be forming a Community Placemaking Reference Group for community representatives to provide guidance to the project team during the design phase of the Marion Road and Cross Road overpass. To register your interest in being involved please visit the project website dit.sa.gov.au/TGSP



The level crossing removal process



More information

To find out more about the project and register for future email updates, please contact the project team:

visit: dit.sa.gov.au/TGSP

email: DIT.TGSP@sa.gov.au

call: 1300 794 880

post: GPO Box 1533, Adelaide SA 5001

Have your say

We invite you to now provide your feedback on the **key urban design elements that you would like to see as part of the Marion Road and Cross Road level crossing removals.**

Please provide your feedback by 5pm Friday, 19 May 2023 either via the survey or face-to face at a drop-in community information session.

Feedback survey

You can access the survey by scanning the QR code or by visiting the project website dit.sa.gov.au/TGSP If you would like a hard copy of the survey, please contact the project team.

Community information sessions

You can also drop in to see what's planned, give your feedback and speak with members of the project team at the following location.

Plympton Glenelg RSL

464 Marion Road, Plympton Park SA 5038

Thursday 4 May 2023 5pm - 8pm &

Saturday 6 May 2023 noon - 4pm



We are holding these information sessions after the busy Easter and school holiday period. However, if you would like to speak to the project team earlier, please don't hesitate to get in touch with us.

Artist impression only – view from Wattle Terrace looking west
Community feedback will inform urban design elements of the overpass



dit.sa.gov.au



Australian Government



Government of South Australia

Department for Infrastructure and Transport