

Princes Highway Corridor Upgrade

Roundabout upgrades update, Mount Gambier

We are upgrading the Princes Highway Corridor, from Meningie to the South Australian/Victorian border, to improve long term safety and efficiency for all road users. The \$190 million Princes Highway Corridor program is jointly funded by the Australian (80%) and South Australian (20%) governments.

Thank you for your patience while we have been undertaking critical infrastructure upgrade works in Mount Gambier.

What's happening

Following completion of the pavement works between Suttontown Road and Wehl Street North in early June 2024, final asphaltting and line marking at the Penola Road roundabout will commence to improve road quality and safety.

From July 2024 finishing works including kerbing works and line marking will be undertaken between O'Leary Road and Penola Road.

How this affects you

There will be changes to traffic conditions to keep everyone safe. Access along the Jubilee Highway West through the roundabout for eastbound and westbound traffic will remain open under speed and lane restrictions.

Access to the southern side of Penola Road will be closed on Monday, 17 June and Thursday, 20 June 2024. Access to the northern side of Penola Road will be closed on Tuesday, 18 June and Wednesday, 19 June 2024. Road closures will only occur during work hours. Other traffic restrictions on Jubilee Highway will be localised lane closures where required during working hours only.

Works will occur on one side of the roundabout at a time. Traffic signage and traffic controllers will be in place to guide motorists around the closures. Some noise disturbance can be expected at times while these works are completed, however we will minimise disturbance as much as practically possible. You might also notice some odours, which is normal during asphalt work.

When

June 2024 – mid 2024, weather permitting.

Hours of operation

6.30am – 6pm
Monday to Saturday.

Where

Penola Road/Jubilee Highway West (Princes Highway) roundabout



Australian Government



Government of South Australia

Department for Infrastructure and Transport

All detour maps, including for heavy vehicles, can be viewed overleaf and on the project webpage at www.dit.sa.gov.au/princes

Local bus routes will still be operating with minor detours in place around the works.

Minor works including line marking will be required following the completion of these works under short-term speed and lane restrictions. Works are expected to be fully completed by mid-2024.

We appreciate that works within Mount Gambier have been ongoing for an extended period of time while we undertake these important upgrades. We have experienced a number of program impacts, including inclement weather, throughout the upgrades. We would like to thank you for your patience and understanding while these critical upgrade works are undertaken.

When these works are completed, they will support South Australia's regional economic growth, provide upgrades to regional road networks for improved accessibility and community connectivity, enhance opportunities for regional tourism in South Australia and improve long term safety and efficiency for all road users.

For further information:

- Visit dit.sa.gov.au/princes
- Contact the project team via DIT.Engagement@sa.gov.au
- Call 1300 794 880

Heavy Vehicle Detour Map

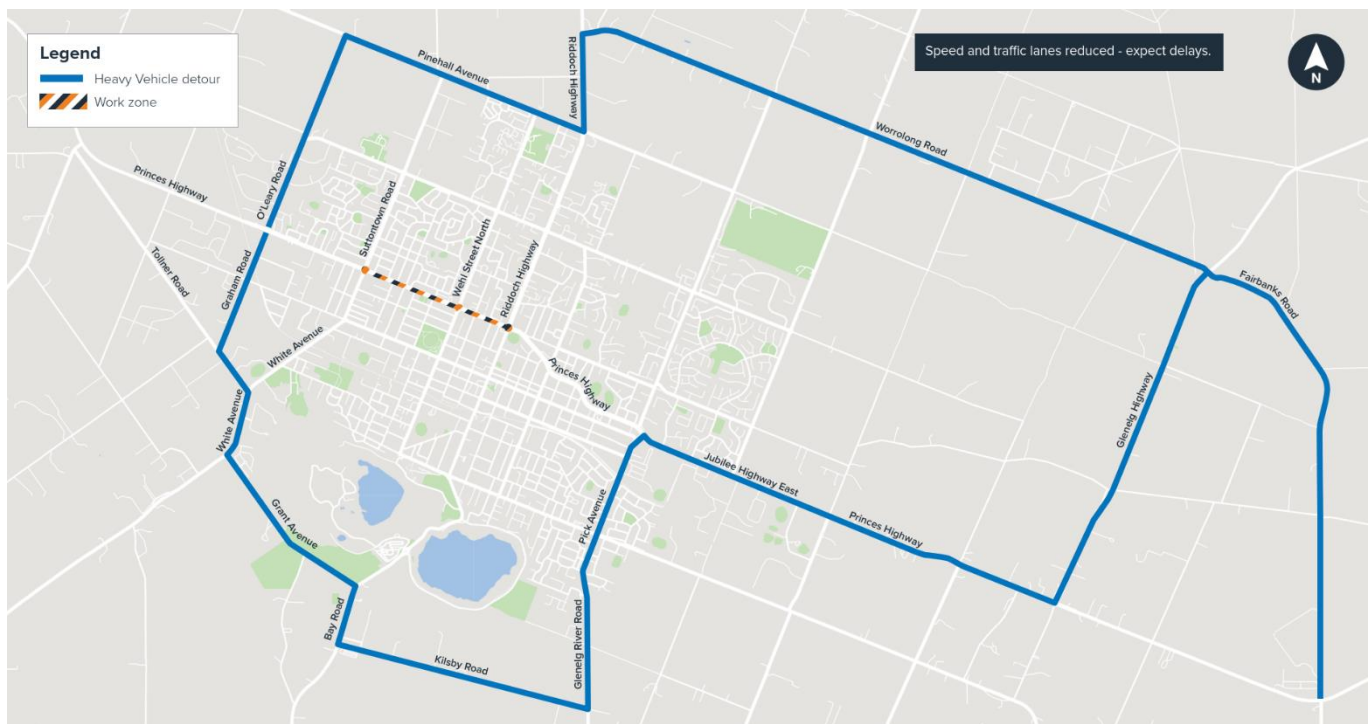

Penola roundabout southern detour map

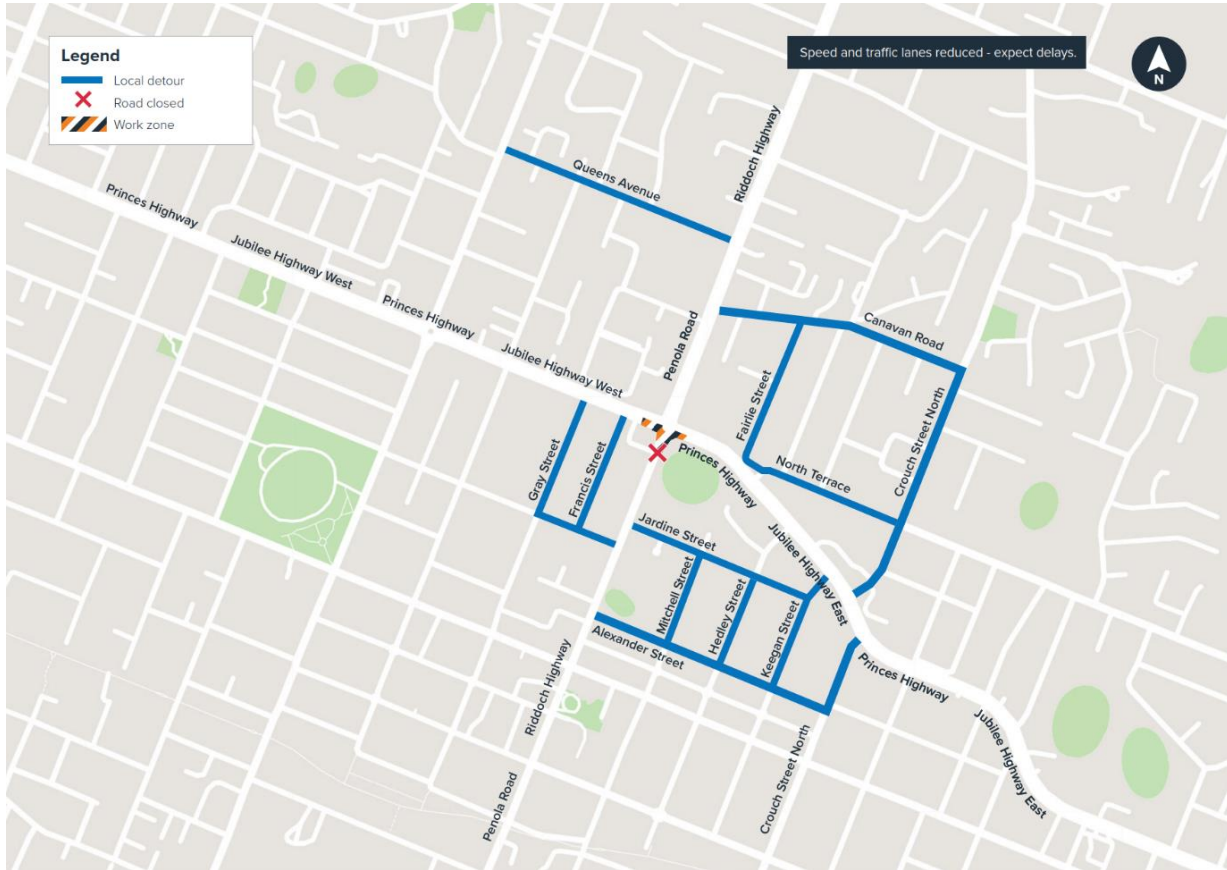

Penola roundabout northern detour map

