

North-South Corridor

Northern Connector Project

South Road Superway closures and detours – night works

As part of the Northern Connector Project, night works will be undertaken on the South Road Superway in separate stages as part of the final works for the Southern Interchange.

Monday 17 February, night works:

The South Road Superway (southbound lanes) between the Salisbury Highway off-ramp to South Road Superway and Regency Park will be closed.

Work hours: From 8pm Monday 17 February, until 5am Tuesday 18 February, weather permitting.

Traffic Management: Southbound access to the South Road Superway will be maintained via a detour onto the Port River Expressway, Hanson and Grand Junction Roads, refer to detour map 1.

Tuesday 18 February, night works:

The South Road Superway (northbound lanes) between Regency Park and the off-ramp to Salisbury Highway will be closed.

Work hours: From 8pm Tuesday 18 February, until 5am Wednesday 19 February, weather permitting.

Traffic Management: Northbound access to the South Road Superway will be maintained via 2 detour options, refer to detour map 2.

Wednesday 19 February, and Thursday 20 February, night works:

The South Road Superway off-ramp to Salisbury Highway will be closed.

Work hours:

- From 8pm Wednesday 19 February, until 5am Thursday 20 February, and
- From 8pm Thursday 20 February, until 5am Friday 21 February, weather permitting.

Traffic Management: Access to the Salisbury Highway will be maintained via a detour to the Hanson Road Interchange, refer to detour map 3.

Speed and lane restrictions will apply in the vicinity of all these works, including the South Road Superway, Salisbury Highway and Port River Expressway. Signage and traffic management will be in place to advise motorists of changed conditions. Thank you for your patience while these important works are undertaken.

More information: To sign up for traffic updates, please contact the Project Information Line on 1300 916 221 or email your contact details to northernconnector@lendlease.com.

Follow www.facebook.com/DPTISA for regular project updates.

#15099701

For further information:

Call: 1300 916 221

Email: northernconnector@lendlease.com

Visit: dpti.sa.gov.au/northernconnector



Government of South Australia

Department of Planning,
Transport and Infrastructure

South Road Superway Southbound closure and detour 1 - Monday 17 Feb



For further information
Visit: dpti.sa.gov.au/northernconnector
Email: northernconnector@lendlease.com
Call: 1300 916 221



Government of South Australia
Department of Planning,
Transport and Infrastructure

South Road Superway Northbound closure and detour 2 – Tuesday 18 Feb

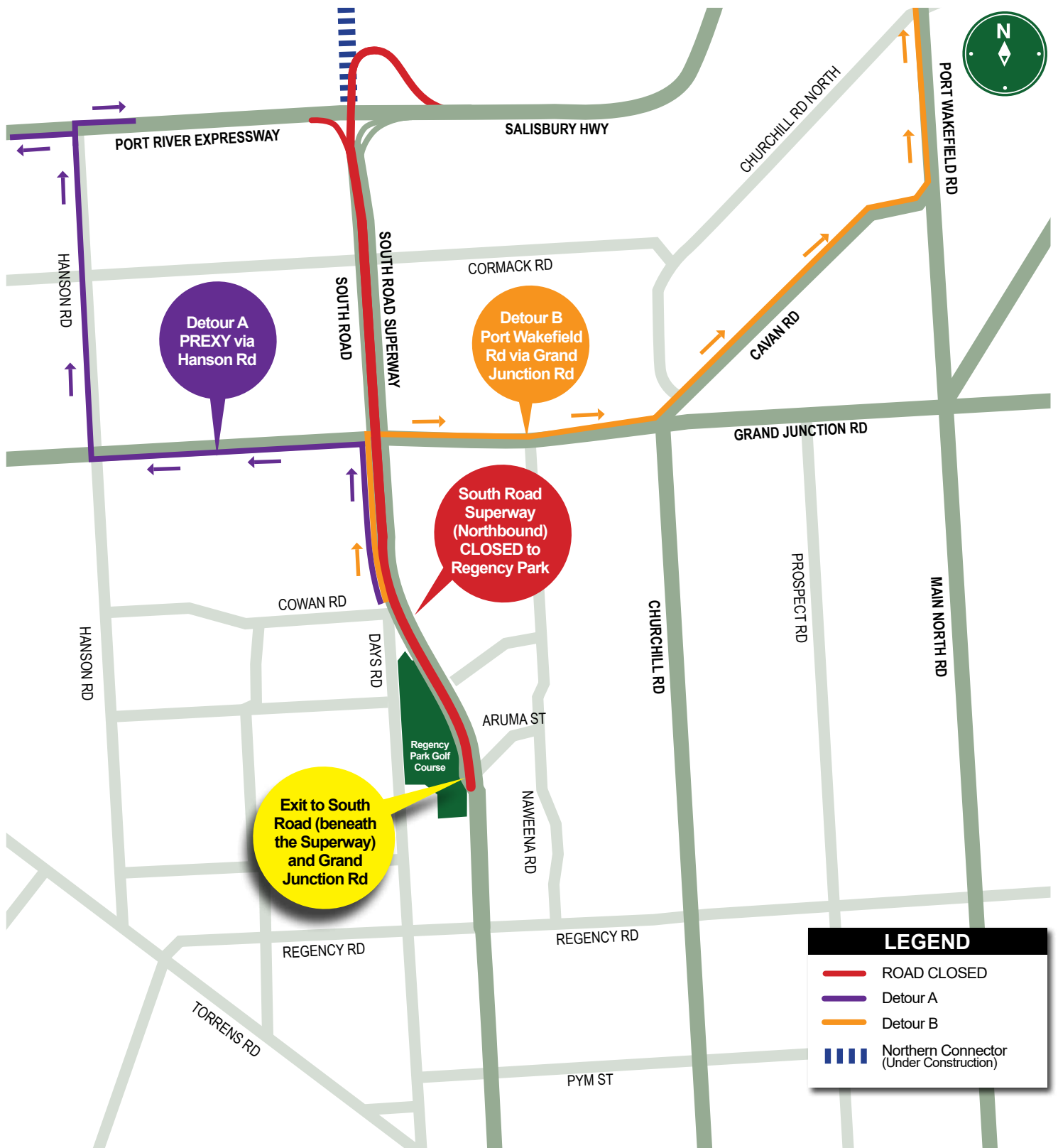

For further information
 Visit: dpti.sa.gov.au/northernconnector
 Email: northernconnector@lendlease.com
 Call: 1300 916 221



Government of South Australia
 Department of Planning,
 Transport and Infrastructure

South Road Superway closure and detour 3 – 19-20 Feb

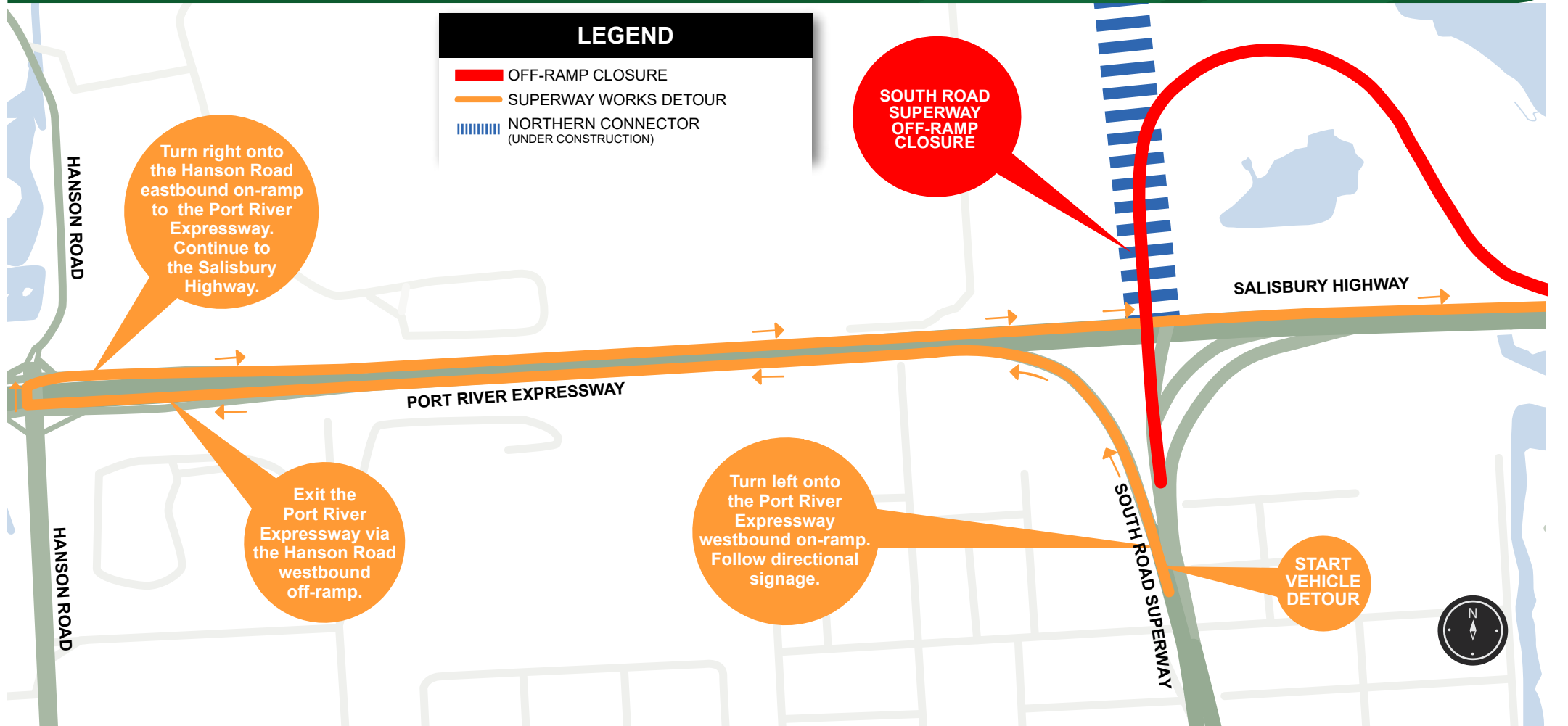

For further information
Visit: dpti.sa.gov.au/northernconnector
Email: northernconnector@lendlease.com
Call: 1300 916 221