

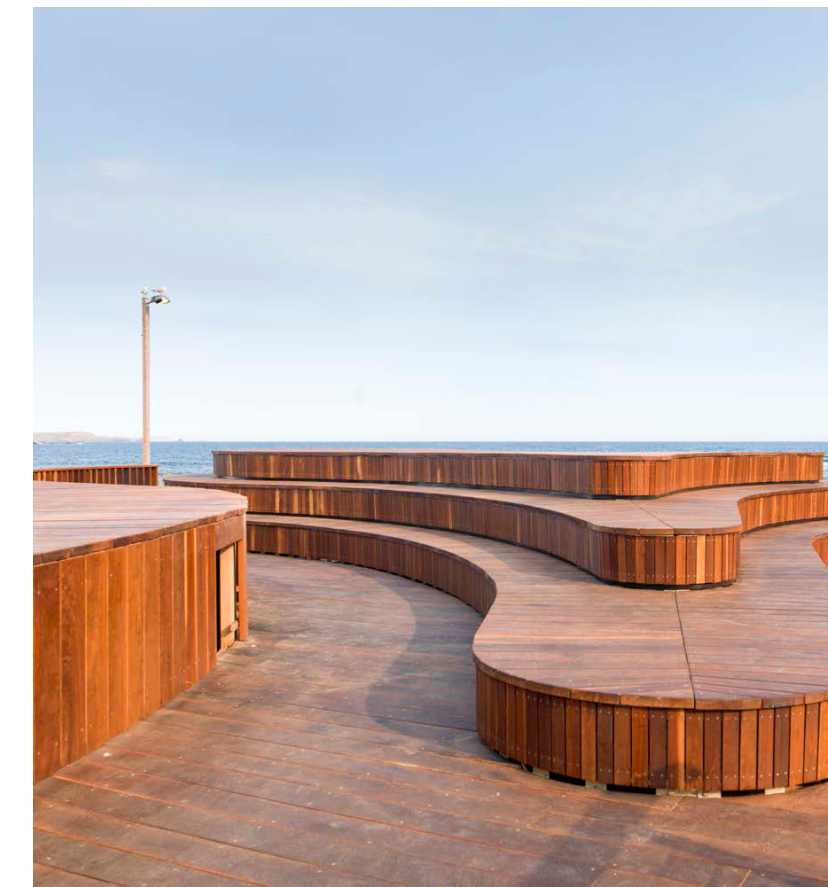

Victor Harbor Landing

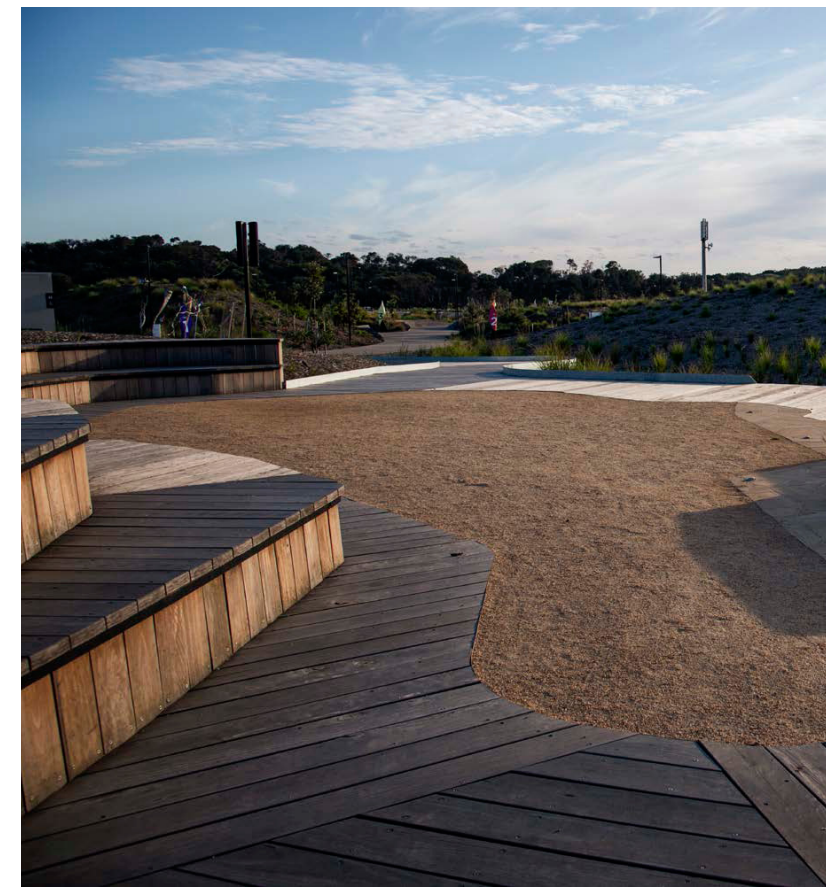

LEGEND

- 1 New relocated tram stop
- 2 Existing fixed + removable bollards to be retained
- 3 Boom gate protected and retained
- 4 Sculptural elements by others
- 5 Bike racks
- 6 Dune vegetation remediation
- 7 Public furniture using reclaimed timber
- 8 Bike hire station retained and relocated
- 9 Viewing deck. Cultural gathering space
- 10 Raised timber benched seating
- 11 Horse stables and tramway building
- 12 Partial retention + reconstruction of old causeway jetty
- 13 Planter and trees - opportunity to adjust arrangement in conversation with tram operation requirements - refer to planting palette for indicative plant varieties
- 14 Beach access
- 15 Interpretive and wayfinding signage
- 16 Garden bed with plantings and trees added to maximise sight lines to Granite Island
- 17 Tactile surface indicators at steps or ramps
- 18 Painted bike rumble strips
- 19 Picnic tables

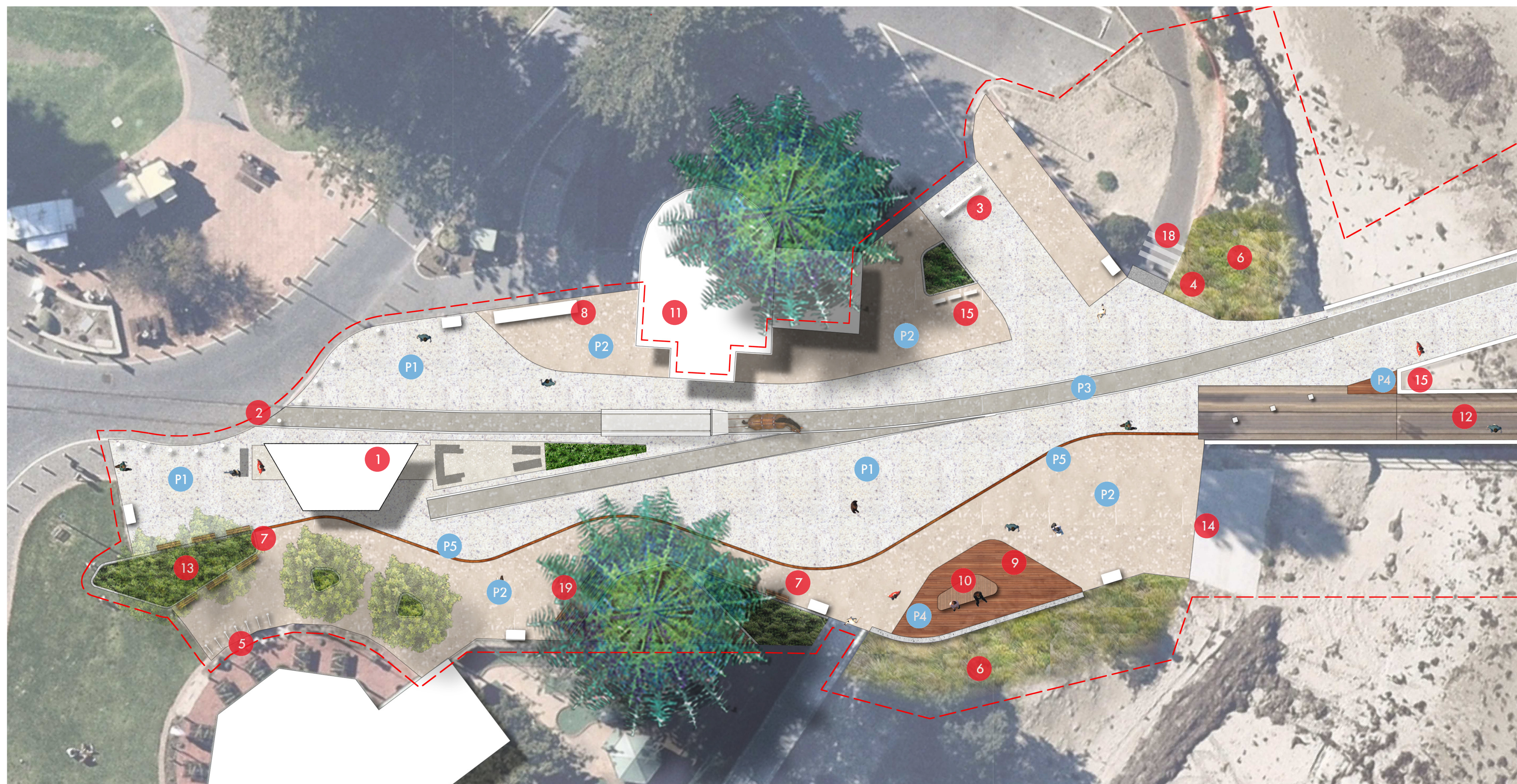

PAVING TREATMENT

- P1 Exposed aggregate concrete
- P2 Exposed aggregate concrete
- P3 Equestrian matting
- P4 Hardwood timber deck
- P5 Steel Inlay



DIT.gicauseway@sa.gov.au

1300 794 880

Follow us on:



Government of South Australia



BUILDING WHAT MATTERS