

# North-South Corridor

## Northern Connector Project

### South Road Superway night works – off-ramp closure and detour

As part of the Northern Connector Project, the South Road Superway off-ramp to Salisbury Highway will be closed for approximately two nights with detours in place.

#### Work hours:

- From 8pm Monday 10 February, until 5am Tuesday 11 February, and
- From 8pm Tuesday 11 February, until 5am Wednesday 12 February, weather permitting.

**Activities:** Relocation of safety barriers, installation of light poles and new line marking.

**Traffic management:** Access to the Salisbury Highway will be maintained via a detour to the Hanson Road Interchange (refer to map).

Speed and lane restrictions will apply in the vicinity of the works, including the South Road Superway.

Signage and traffic management will be in place to advise motorists of changed conditions.

Thank you for your patience while these important works are undertaken.

**More information:** To sign up for traffic updates, please contact the Project Information Line on 1300 916 221 or email your contact details to [northernconnector@lendlease.com](mailto:northernconnector@lendlease.com).

For real time roadwork information visit [www.addinsight.com.au](http://www.addinsight.com.au) and download the app, available for both Apple and Android, or visit the Traffic SA website at [www.traffic.sa.gov.au](http://www.traffic.sa.gov.au).

Follow [www.facebook.com/DPTISA](https://www.facebook.com/DPTISA) for regular project updates.

#15084393

#### For further information:

Call: 1300 916 221

Email: [northernconnector@lendlease.com](mailto:northernconnector@lendlease.com)

Visit: [dpti.sa.gov.au/northernconnector](http://dpti.sa.gov.au/northernconnector)

# Detour for South Road Superway night works

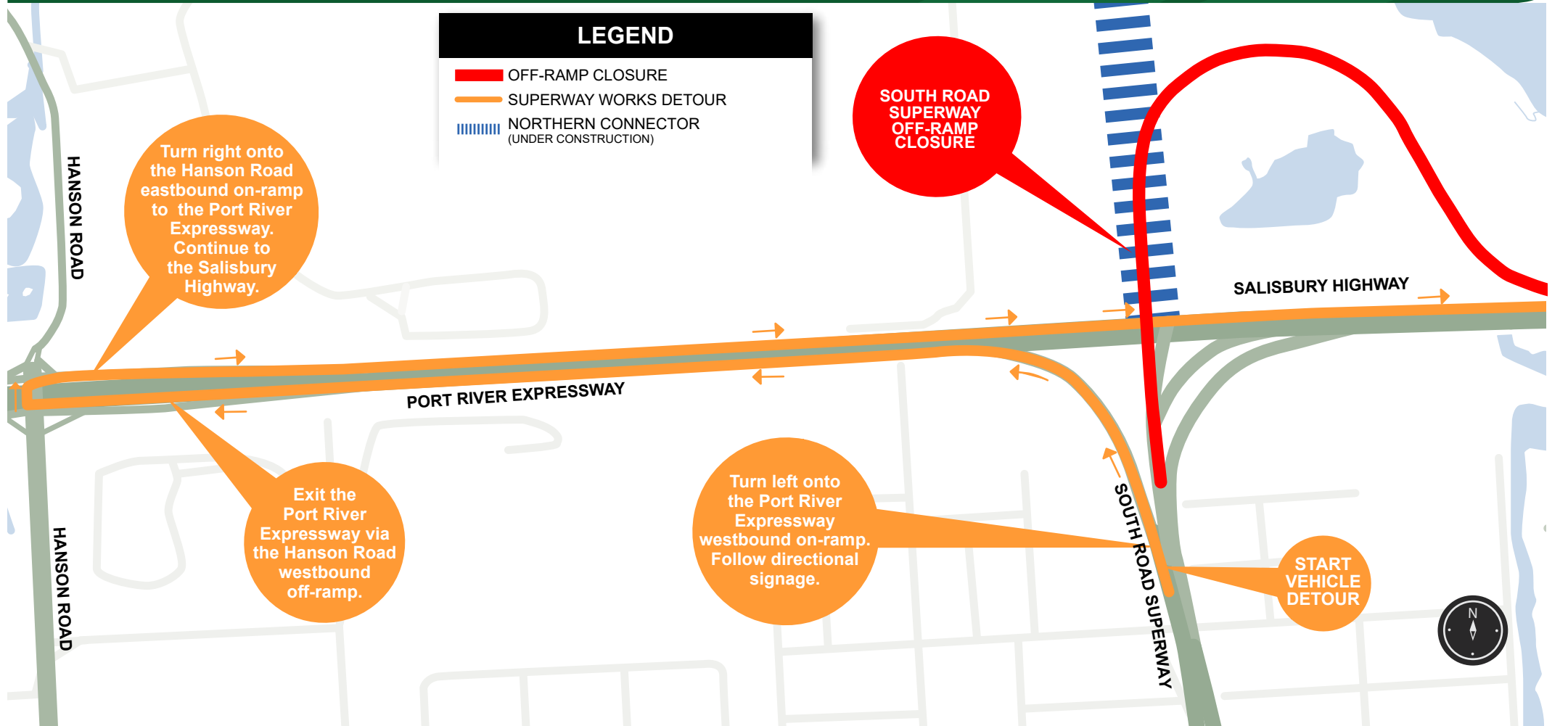

For further information  
Visit: [dpti.sa.gov.au/northernconnector](http://dpti.sa.gov.au/northernconnector)  
Email: [northernconnector@lendlease.com](mailto:northernconnector@lendlease.com)  
Call: 1300 916 221